

THE COPYRIGHT OF THIS DRAWING IS VESTED WITH CW O'BRIEN ARCHITECTS LIMITED AND MUST NOT BE COPIED OR REPRODUCED WITHOUT THE CONSENT OF THE COMPANY.  
 FIGURED DIMENSIONS ONLY TO BE TAKEN FROM THIS DRAWING. DO NOT SCALE.  
 ALL CONTRACTORS MUST VISIT THE SITE AND BE RESPONSIBLE FOR CHECKING ALL SETTING OUT DIMENSIONS AND NOTIFYING THE ARCHITECT OF ANY DISCREPANCIES PRIOR TO ANY MANUFACTURE OR CONSTRUCTION WORK.

**DESIGN INTENT DRAWING**

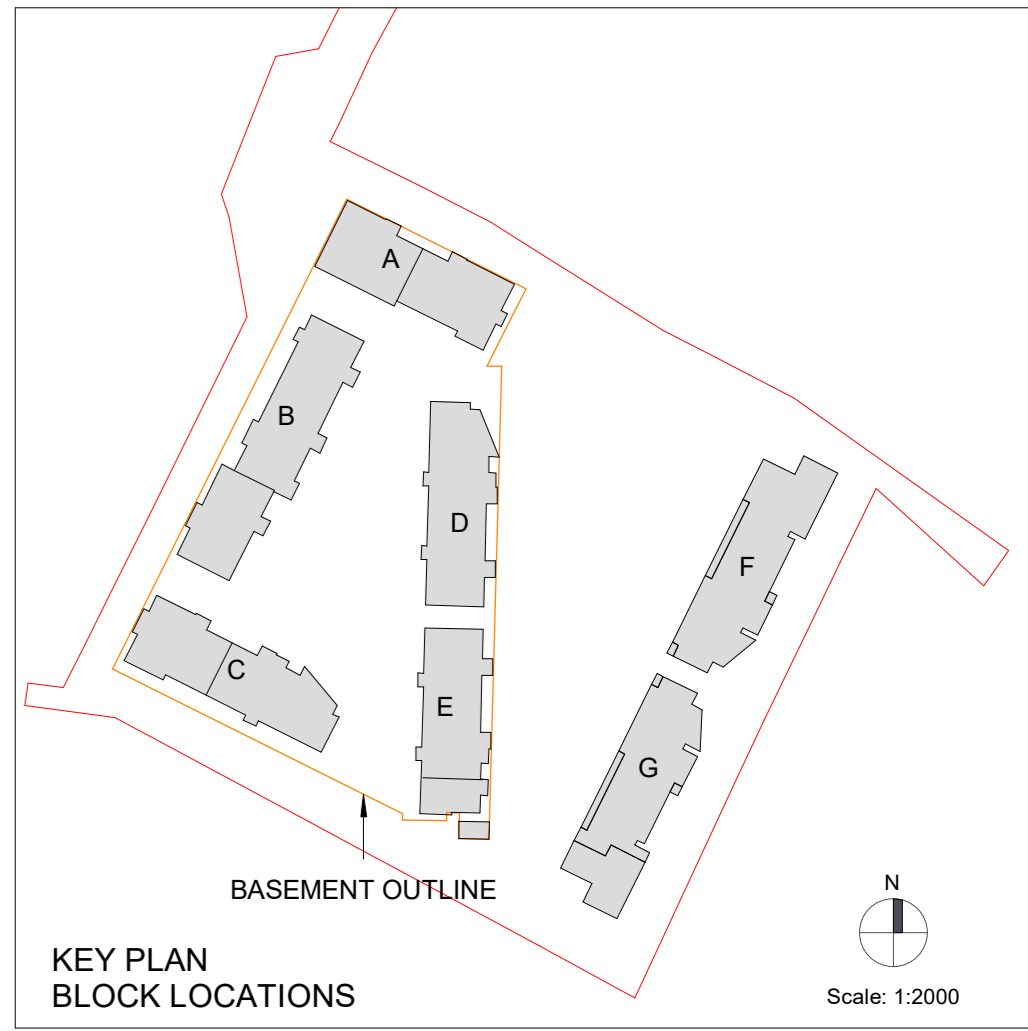

APPLICATION BOUNDARY

**TOTAL PROPOSED CAR PARKING SPACES**

- BASEMENT:**
- no. 249 RESIDENTS PARKING (5 of them are for electric vehicles)
  - no. 5 CRECHE STAFF
  - no. 18 ACCESSIBLE PARKING
  - no. 5 CAR SHARE / CAR CLUB
- SURFACE LEVEL:**
- no. 37 RESIDENTS PARKING
  - no. 4 ACCESSIBLE PARKING
  - no. 19 VISITORS PARKING (5 of them are drop-off parking)
- A TOTAL OF 317 CAR PARKING SPACES PROVIDED  
313 OF WHICH FOR RESIDENTS**
- no. 14 MOTORCYCLE PARKING
  - no. 732 SECURE CYCLE SPACES
  - no. 238 VISITOR CYCLE SPACES
  - no. 14 CARGO BIKE SPACES
- A TOTAL OF 962 CYCLE SPACES PROVIDED**



**1 SITE PLAN**  
1:500

Rev	Date	Description	Issued By
Project Stage			
<b>PLANNING</b>			
Client			
Eastwise Construction Swords Limited			
Project			
Hartfield Place Swords Road, Whitehall, Dublin 9 D09 C7F8			
Drawing Title			
SITE PLAN			
Drawn	Checked	Paper Size	Scale
DP	CM	A0	As Indicated
Date			
Mar. 2022			
Project No.	Drawing No.	Classification	Revision
HARTPL	000502		
File Name			
HARTPL-CWO-SM-00-DR-A-000502			
Status			
S2-Suitable For Information			